

TransVision

SHIELD™

Instantly darkens to protect your eyes



Even before the arc flash, the TransVision Shield™ reacts. It auto-darkens instantly to protect the eyes from temporary blindness and permanent eye damage.



Arc flash is one of the top safety hazards that a lineman or electrical worker faces, often causing significant eye damage and the loss of situational awareness on the job. Most personal protective equipment is designed to protect workers from debris and heat –but not an arc flash.

In combination with the MSA V-Gard® Protective Cap, the TransVision Shield™ offers maximum protection. It is one of the lightest weight eye, face and head PPE for electrical workers.

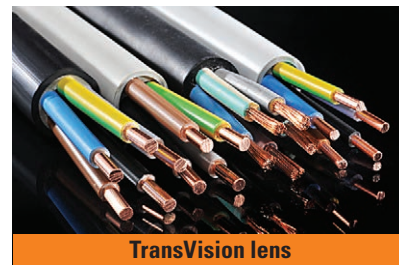

TransVision lens

The specially coated lens gives the wearer a realistic perception of colors and a clearer view of the environment. Colored wires can be easily identified without lifting the visor.



Ergonomic design

The ergonomic design minimizes strain on the head and neck, ensuring comfort throughout the workday.



Innovative optical lens technology

The LCD auto-darkening lens and washable textile (Style FR-Tex CA 350, Arc-rated) are thermally resistant to destruction or ignition when exposed to intense heat and light.

NFPA 70E CAT 4 to meet 55 CAL/CM² ATPV or NFPA 70E CAT 3 to meet 31 CAL/CM² ATPV
Tested ratings in accordance with **ASTM 2178-12** and **ANSI Z87.1** for impact resistance.

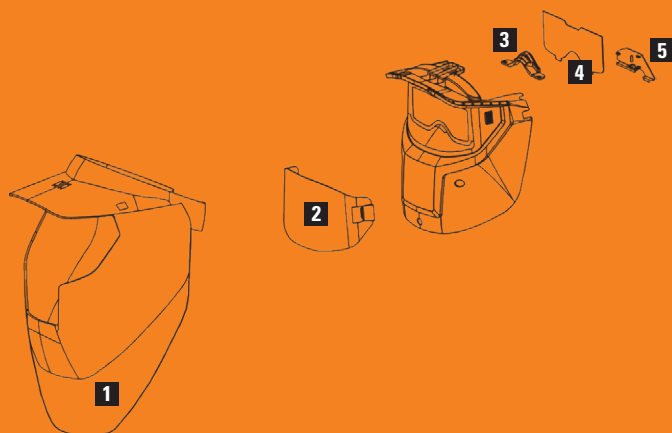

	Part Numbers	
Complete TransVision Shield™	55 cal/cm²	31 cal/cm²
TransVision Shield™ with hard hat	TV55712	TV31712
Spare parts and accessories	55 cal/cm²	31 cal/cm²
1 Textile cap	5002.827	5002.826
2 Front cover lens (5 pcs.)	5000.266	5000.266
3 Nose rest	5002.706	5002.706
4 Inside cover lens (5 pcs.)	5000.046	5000.046
5 Battery cover	5002.726	5002.726

TECHNICAL DATA

Description Lightweight compound, high-arc protector with large viewing area, bright see-through state, ON/OFF operation and low battery warning LED.

Ultraviolet Protection 55 CAL/CM²: U6
31 CAL/CM²: U6

Infra-red Protection 55 CAL/CM²: R2.5

Light transmission - visible range Light - open state: 25 %
Dark - closed state: 0.0012 %

Power supply 2 pcs LI-batteries 3V exchangeable (CR2032)

Battery life Approx. 3000 hours (operating)

Sensors 1 wide angle detection sensor

Switching time Light to dark: 0.16 ms at room temperature – 0.11 ms at 55°C / 131°F
Dark to light: 0.16 ms

Shape stability Mask: up to 220°C / 428°F – Front cover lens: up to 137°C / 279°F

Protection for LCD Reflection-free front cover lens and inside cover lens

Operating temperature -10°C to + 60°C / 14°F to 158°F

Storage temperature -20°C to + 80°C / -4°F to 176°F

Weight Mask with lens: 233g / 8.2 oz.
Textile cap 55 cal/cm²: 350 g / 12.3 oz.
Textile cap 31 cal/cm²: 350 g / 12.3 oz.

Application ranges Used by electrical workers exposed to momentary electric arc and related thermal hazards. Prohibited for welding!

Includes TransVision Shield, hard hat,* instruction manual, batteries

ATPV rating 55 CAL/CM²: 55 cal/cm²
31 CAL/CM²: 31 cal/cm²

Hazard Risk Categories - NFPA 70E 55 CAL/CM²: CAT 4
31 CAL/CM²: CAT 3

Industry Standards 55 CAL/CM²: ANSI Z87.1 U6 /ASTM F2178 /ASTM F1506.10a
31 CAL/CM²: ANSI Z87.1 U6 & R2.5 /ASTM F2178 /ASTM F1506.10a

Warranty 2 years (except batteries and textile)



STANCO
SAFETY
PRODUCTS

2004 West Main St.
Atlanta, TX 75551
800-348-1148
www.stancofmg.com

*Available without the hard hat. Call for details